



FG

METAL FITTINGS OF TERMINAL

FLEXIBLE	GLAND
FG12	Φ 12mm
FG14	Φ 14mm
FG16	Φ 16mm
FG20	Φ 20mm
FG25	Φ 25mm
FG32	Φ 32mm
FG40	Φ 40mm
FG50	Φ 50mm
FG63	Φ 63mm



PG

PG1 CABLE GLAND

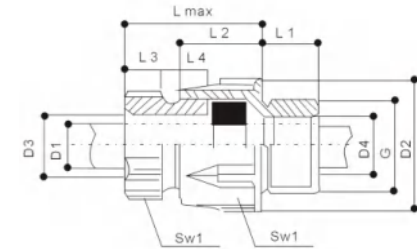

Color: light grey or black



MG

MG CABLE GLAND

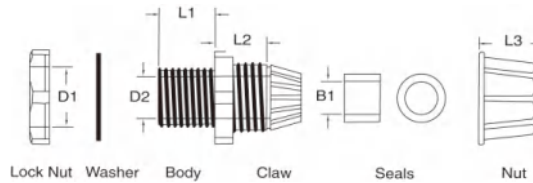

Type	Sealing Area D 1mm	D2 mm	D3 mm	D4 mm	key Size		L1 mm	L2 mm	L3 mm	L4 mm	Lmax mm
					SW1	SW2					
PG7	3.5-6.5	16.5	7	7	15	13	8	13	5	8.5	23
PG9	4.5-7	21.5	10.2	10.2	19	16	8	14	5	9	25
PG11	5.5-10	25	11.3	11.5	22	19	8	15	5	10	27
PG13.5	9-13	27	11.4	13.5	24	21	9	16	5	10.8	28
PG16	10-14	30	15.8	16.5	27	23	10	16.5	5	12	30
PG21	14-18	37.5	21.2	21	33	30	11	19	6	17	38
PG29	18-25	47.5	30	27.5	42	40	11	20.5	7	18	42
PG36	35-33	58	48	34.5	53	50	12	24	8	17	43
PG42	30-38	65	44.5	40.5	60	55	13	27	9	18.5	48
PG48	37-44	70	50	45.5	65	65	14	27	9	18.5	48

Unit:mm

Item NO	Mounting Hole D1 (mm)	D2(mm)	B1 (mm)	L1(mm)	L2 (mm)	L3(mm)	Cable Range	Packing
G-M12	12	8.3	5.0	7.9	12.1	13.3	3~6.5	50pcs
G-M16	16	10.9	9.6	14.4	14.4	16.7	5~10	
G-M20	20	14.8	12.9	19.5	19.5	18.4	10~14	
G-M25	25	18.5	16.5	19.5	19.5	22.3	13~18	
G-M32	32	25.9	23.3	20.3	20.3	26.1	18~25	25pcs
G-M40	40	31.4	30.6	23.4	23.4	31.9	22-32	
G-M50	50	41.2	38.2	25.7	25.7	31.6	30~38	10pcs
G-M63	63	54.1	42.4	26.2	26.2	32.6	34~44	

Color: light grey or black



SM5

SHRINKABLE TUBE

mm		SET
Sm5 1.5-6	5 x 1.5 - 6	5+1
Sm5 1.5-16	5 x 1.5 - 16	5+1
Sm5 16-25	5 x 16 - 25	5+1
Sm4 6-25	4 x 6 - 25	4+1
Sm4 16-50	4 x 16 - 50	4+1
Sm4 25-95	4 x 25 - 95	4+1
Sm4 35-150	4 x 35 - 150	4+1
Sm4 70-150	4 x 70 - 150	4+1
Sm4 95-300	4 x 95 - 300	4+1



PGEC11

WATERPROOF JOINT(DOUBLE-END CONNECTOR)CONNECTOR

Wiring Size (mm ²)	Outer Diameter(mm)
2 x 0.2	4.2
2 x 0.3	5.0
2 x 0.5	5.8
2 x 0.75	6.0
2 x 1	6.8
2 x 1.5	7.8
2 x 2.5	9.6
2 x 4	11.5
2 x 6	13

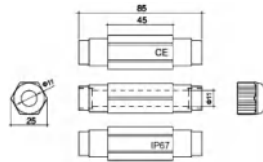

PGEC13

WATERPROOF JOINT(DOUBLE-END CONNECTOR)CONNECTOR

Wiring Size (mm ²)	Outer Diameter(mm)
3 x 0.2	4.4
3 x 0.3	5.3
3 x 0.5	6.2
3 x 0.75	6.4
3 x 1	7.15
3 x 1.5	8.45
3 x 2.5	10.4
3 x 4	12.3
3 x 6	13.5

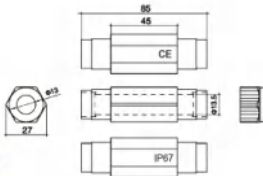

mm11

CABLE JOINT(1.2KV)

Straight type

CL	Dim(Φ)	mm ²	MX Y(mm)
MM10	6 - 19	5 x 2.5	160 x 36
MM11	6 - 25	5 x 6	190 x 48
MM12	14 - 35	4 x 16	240 x 50
MM13	16 - 37	4 x 25	270 x 65
MM14	20 - 44	4 x 50	360 x 80
MM15	26 - 52	4 x 95	430 x 95
MM16	35 - 65	4 x 150	530 x 120
MM17	45 - 80	4 x 240	700 x 180

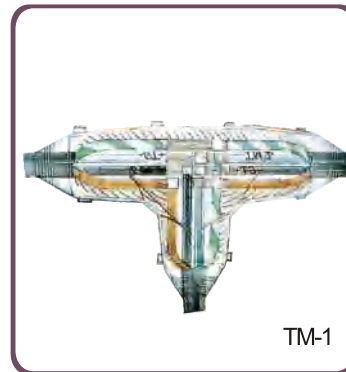

TM-1

Tri-pole Type

TM-1	5 x 1.5-5 x 10	240 x 140 x 10
TM-2	5 x 6-5 x 16	270 x 164 x 77





INSULATED STRIP BLOCKS LT-12 POLES ONE-POLE

INSULATED STRIP BLOCKS LT

Technical Date

Built and tested according to UNE-EN60998 Standard. Insulating part and crews: Polyamide 6 natural colour. Flammability to UL 94 V2. Continuous working temperature: 115 ° Short time working temperature: 160 ° Conductor block and screws; Nickel-plated brass.

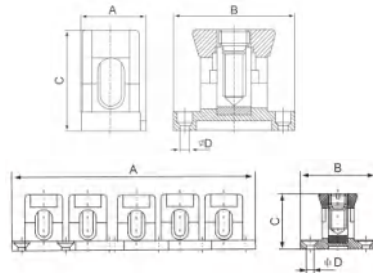

Type	Characteristics	dimensiones/dimensions				Sistema ALLEN ALLEN System	
		A	B	C	ΦD		
LT-6	Conductor size up to	2×6	188	29	17	3,2	
	Voltage rating	500V					
LT-10	Conductor size up to	2×10	224	31	23	3,2	
	Voltage rating	500V					
LT-16	Conductor size up to	2×16	260	32	26	3,2	
	Voltage rating	500V					
LT-25/35	Conductor size up to	2×35	308	36	34	3,2	
	Voltage rating	500V					
LT-50	Conductor size up to	2×50	32	63	48	5	5
	Voltage rating	500V					
LT-70	Conductor size up to	2×70	34	63	53	5	6
	Voltage rating	500V					
LT-95	Conductor size up to	2×95	39	63	56	5	8
	Voltage rating	500V					
LT-120	Conductor size up to	2×120	41	70	61	5	8
	Voltage rating	500V					

Standard Type: Maximum ambient temperature, T100 according to EN-UNE 60998, natural color



DGF028 84



DGF028 85



DGF028 86



DGF048 88

MODULAR DISTRIBUTION BLOCKS 40-100 TO 400A

Connection with or without ferrules
Supplied with insulated back plate and transparent protective front cover, self-extinguishing 960 mounting methods:

- on rail
- on plate with 2 screws

When installing under a front plate, a blanking plate can be clipped onto the front plate
Insulation protection on each bar

Each bar can be labelled using cab 3™
Conform to standard EN60947-1
ICC: 20kA peak

Double pole

Dimensions W x H x L (mm)	Number of connections per busbar	Number of . φ 5mm modules
100A 42x44x70	7	4
125A 42x44x140	15	8
Four pole 40A 105x86x50	13	6
100A 86x44x70	7	4
125A 86x44x105	11	6
86x44x140	15	8

- (1) ICC: 18 kA peak
- (2) FCC: 14 5kA peak



DGF160A

MODULAR DISTRIBUTION BLOCKS 40-100 TO 400A

Connection with or without ferrules
 Supplied with insulated back plate and transparent protective front cover, self-extinguishing 960 mounting methods:

- on rail
- on plate with 2 screws

When installing under a front plate, a blanking plate can be clipped onto the front plate

Insulation protection on each bar

Each bar can be labelled using cab 3™

Conform to standard EN60947-1
 ICC: 20kA peak



DGF200A

Distribution block Cat. Nos. and number of connections per busbar	Conductors with starfix ferrules X-section (mm ²)	Cond. w/out ferr. X-section (mm ²)
5xΦ5.3mm 2xΦ7.5mm	1.5 to 6 6 to 16	2.5 to 6 10 to 25
5xΦ5.3mm 2xΦ7.5mm 10xΦ5.3mm	1.5 to 6 6 to 16 10 to 16	2.5 to 6 10 to 25 10 to 35
2xΦ7.5mm 2xΦ9mm	1.5 to 6 6 to 16	2.5 to 6 10 to 25
10xΦ5.3mm 2xΦ7.5mm 2xΦ9mm	1.5 to 6 6 to 16 10 to 16	2.5 to 6 10 to 25 10 to 35
10xΦ5.3mm 2xΦ7.5mm 2xΦ9mm	1.5 to 6 6 to 16 10 to 16	2.5 to 6 10 to 25 10 to 35

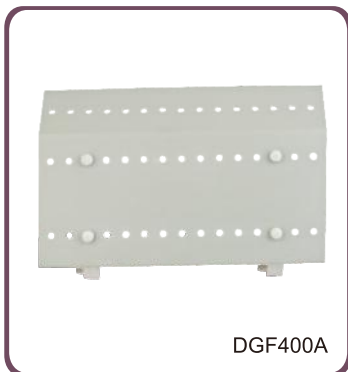

DGF400A

160A	4x200A	4x250A	4x400A
------	--------	--------	--------

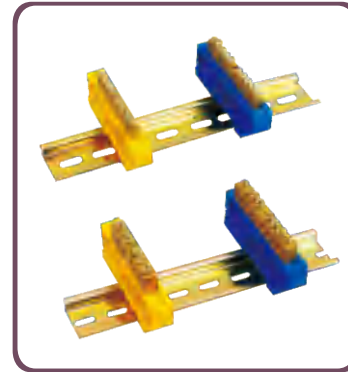

BRASS TERMINAL EARTHING & NEUTRAL LINK (BUSBAR)

Way	Mm(L)	Mm(L ₁)	mm (Section cross of brass)
4	35X7.5	88.5X12.1	6X9
6	35X7.5	88.5X12.1	6X9
8	35X7.5	88.5X12.1	6X9
10	35X7.5	88.5X12.1	6X9
12	35X7.5	90.5X12.1	6X9
14	35X7.5	103.5X12.1	6X9
16	35X7.5	116.5X12.1	6X9

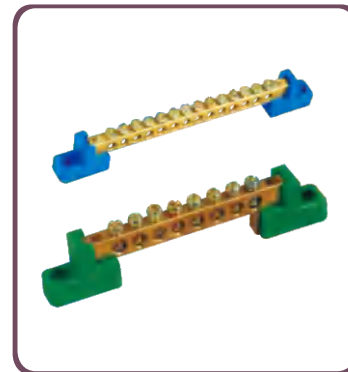
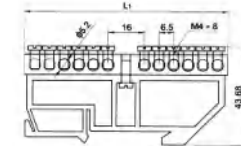

Way	Mm(L)	Mm(L ₁)	mm (Section cross of brass)
4	35X7.5	88.5X12.1	8X12
6	35X7.5	88.5X12.1	8X12
8	35X7.5	88.5X12.1	8X12
10	35X7.5	88.5X12.1	8X12
12	35X7.5	102X12.1	8X12
14	35X7.5	117X12.1	8X12
16	35X7.5	132X12.1	8X12

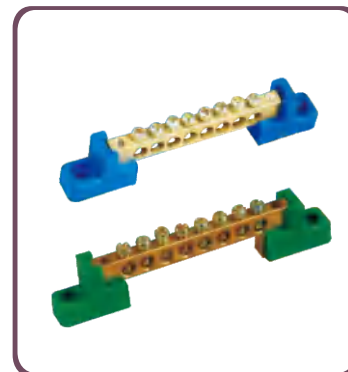
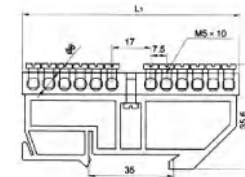

Way	Mm(L)	Mm(L ₁)	mm (Section cross of brass)
4	64.5	76.5X12.5	6X9
6	77.5	89.5X12.5	6X9
8	90.5	102.5X12.5	6X9
10	103.5	115.5X12.5	6X9
12	116.5	128.5X12.5	6X9
14	129.5	141.5X12.5	6X9
16	142.5	154.5X12.5	6X9

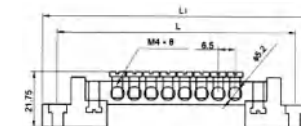



BRASS TERMINAL EARTHING & NEUTRAL LINK(BUSBAR)

Way	Mm(L)	Mm(L ₁)	mm (Sectioncrossof brass)
4	71.5	84.5X12.5	8X12
6	86.5	99.5X12.5	8X12
8	101.5	114.5X12.5	8X12
10	116.5	129.5X12.5	8X12
12	131.5	144.5X12.5	8X12
14	146.5	159.5X12.5	8X12
16	161.5	174.5X12.5	8X12

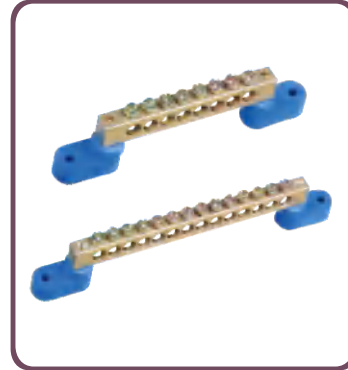
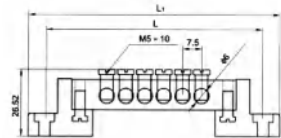

BLOCK SERIES

Way	mm (L)	mm (L ₁)	mm (Sectioncross of brass)
4	69.5	82.5X13	6X9
6	82.5	95.5X13	6X9
8	95.5	108.5X13	6X9
10	108.5	121.5X13	6X9
12	121.5	134.5X13	6X9
14	134.5	147.5X13	6X9
16	147.5	160.5X13	6X9

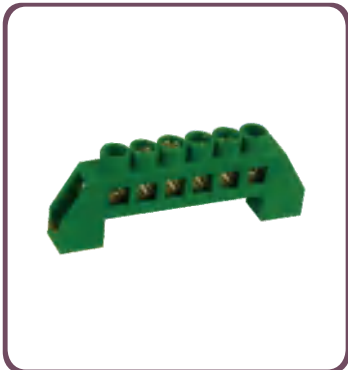
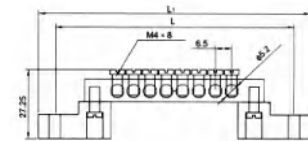

Way	Mm(L)	Mm(L ₁)	mm (Sectioncrossof brass)
4	48.2	59.2X11.2	6X9 8X12
6	65.4	76.4X11.2	6X9 8X12
8	82.6	93.6X11.2	6X9 8X12
10	99.8	110.8X11.2	6X9 8X12
12	117	128X11.2	6X9 8X12

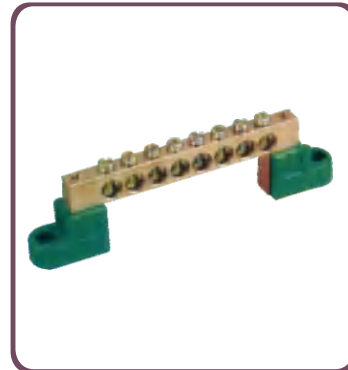
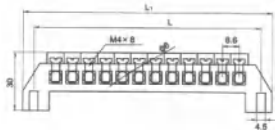

Way	mm (L)	mm (L ₁)	mm (Sectioncross of brass)
4	69	85X15.8	8X12
6	84	100X15.8	8X12
8	99	115X15.8	8X12
10	114	130X15.8	8X12
12	129	145X15.8	8X12
14	144	160X15.8	8X12
16	159	175X15.8	8X12

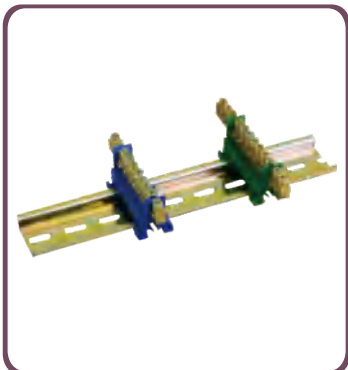
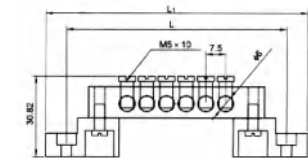

Way	Mm(L)	Mm(L ₁)	mm (Sectioncrossof brass)
7	35X7.5	50X21	6X9
8	35X7.5	57X21	6X9
10	35X7.5	71.5X21	6X9
12	35X7.5	84.5X21	6X9
13	35X7.5	91X21	6X9
15	35X7.5	104X21	6X9

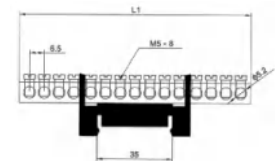

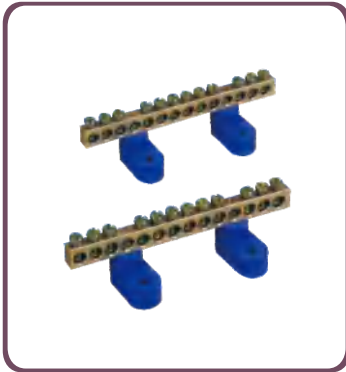

BRASS TERMINAL EARTHING & NEUTRAL LINK(BUSBAR)

Way	mm (L)	mm (L ₁)	mm (Sectioncross of brass)
6	44.5	58.5X29	6X9
8	44.5	65.5X29	6X9
10	44.5	78.5X29	6X9
12	44.5	91.5X29	6X9
14	44.5	104.5X29	6X9
16	44.5	117.5X29	6X9

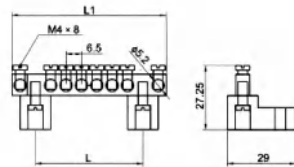

Way	mm (L)	mm (L ₁)	mm (Sectioncross of brass)
6	52.5	68.5X28.5	8X12
8	52.5	77.5X28.5	8X12
10	52.5	92.5X28.5	8X12
12	52.5	107.5X28.5	8X12
14	52.5	122.5X28.5	8X12
16	52.5	137.5X28.5	8X12

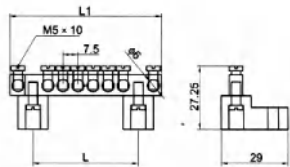

E807

SINGLE HOLE METAL FITTINGS OF TERMINAL

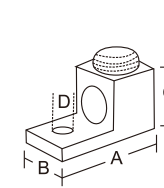

CAT#	A	B	C	D
E805	1.0625	375	0.50	25
E806	1.1563	50	0.5625	25
E807	1.4088	625	0.8125	25
E808	1.4688	525	0.8125	25
E809	2.00	9375	10625	3125
E1810	2.00	8275	10625	3125
E817	2.25	1.125	1.25	3125
E818	2.75	1.125	1.50	375
E1818	2.75	1.375	1.50	375
E819	3.50	1.50	1.75	50
E1820	3.50	1.50	1.25	50



E810

SINGLE HOLE

DAGUAN CAT#	UPC#	AMP RATING	WIRE RANGE MIN	WIRE RANGE MAX	AUNIT CTN	SHIP CASE	WT/ CASE
E805	18160	45	14	6	-	100	2
E806	18170	50	14	2	-	100	2
E807	18180	50	14	1/0	-	50	6
E808	18190	120	14	2/0	-	50	5
E809	18200	275	6	4/0	-	25	3
E1810	18269	275	6	300MCM	10	100	25
E817	18201	375	6	350MCM	-	25	3
E818	18202	500	4	500MCM	-	10	2
E1818	18271	500	9	600MCM	5	50	35
E819	18203	500	350MCM	800MCM	-	5	2
E1820	18272	600	350MCM	10000MCM	6	60	46



E2808

DOUBLE METAL FITTINGS OF TERMINAL

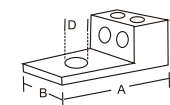

CAT#	A	B	C	D
E2807	1.50	1.1875	0.8125	25
E2808	1.50	1.1875	0.8125	25
E2809	2.5625	1.625	1.1875	375

DOUBLE HOLE

DAGUAN CAT#	UPC#	AMP RATING	WIRE RANGE MIN	WIRE RANGE MAX	AUNIT CTN	SHIP CASE	WT/ CASE
E2807	81830	50	14	1/0	10	100	23
E2808	81831	50	14	2/0	10	100	24
E2809	81832	275	6	250MCM	10	100	26



E2817

DOUBLE METAL FITTINGS OF TERMINAL

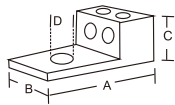

CAT#	A	B	C	D
E2817	2.875	2.9375	1.25	50
E2818	2.375	2.375	1.5625	50
E2819	3.50	2.8125	1.6875	625
E2820	3.50	2.8125	1.6875	625

DOUBLE HOLE

DAGUAN CAT#	UPC#	AMP RATING	WIRE RANGE MIN	WIRE RANGE MAX	AUNIT CTN	SHIP CASE	WT/ CASE
E2817	81833	275	6	250MCM	4	40	20
E2818	81834	375	2	600MCM	4	10	19
E2819	81835	375	300MCM	800MCM	2	20	14
E2820	81836	375	500MCM	1000MCM	2	20	15



E3807

TRIPLE METAL FITTINGS OF TERMINAL

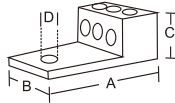

CAT#	A	B	C	D
E3806	2.19	1.59	0.62	3125
E3807	2.19	1.94	0.88	375
E3808	4.1875	2.8125	0.8125	50
E3809	4.1875	3.00	1.25	50
E3817	4.1875	3.00	1.25	50
E3818	4.6875	3.75	1.5625	50

SINGLE HOLE

DAGUAN CAT#	UPC#	AMP RATING	WIRE RANGE MIN	WIRE RANGE MAX	AUNIT CTN	SHIP CASE	WT/ CASE
E3806	41175	50	14	#2	10	100	23
E3807	41176	50	14	1/0	10	100	25
E3808	41177	275	6	3/0	10	100	26
E3809	41178	275	6	250MCM	5	50	17
E3817	41188	275	2	350MCM	5	50	16
E3818	41189	375	2	600MCM	5	50	16



E3817



80-4709-7

80-4709-5

ALUMINUM TERMINALS

Model(mm)	A	B	C	D	Explain
80-4709-5	57.15	25.4	25.4	4.7	MTP1/0-250 MCM
80-4709-7	57.15	25.4	25.4	4.7	MTP1/0-250 MCM
80-4709-8	47.6	19	2.8	4.7	MTP8-1/0 AL/CU
80-4709-9	47.6	19	23.8	4.7	MTP8-1/0 AL/CU

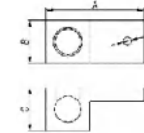

80-4709-8

80-4709-9

ALUMINUM TERMINALS

Model(mm)	A	B	C	D	Explain
80-4709-5	57.15	25.4	25.4	4.7	MTP1/0-250 MCM
80-4709-7	57.15	25.4	25.4	4.7	MTP1/0-250 MCM
80-4709-8	47.6	19	2.8	4.7	MTP8-1/0 AL/CU
80-4709-9	47.6	19	23.8	4.7	MTP8-1/0 AL/CU

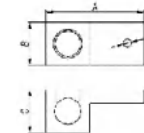

BUSBAR SUPPORT



101

102

Description: Busbars & Links Accessories

Code: 101/102

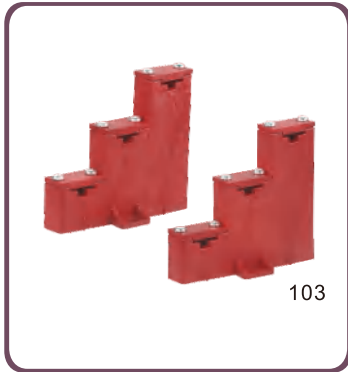

103

BUSBAR SUPPORT

Description: Busbars & Links Accessories

Code: 103



103T

BUSBAR SUPPORT

Description: Busbars & Links Accessories

Code: 103T



NAL5

ACTIVE/NEUTRAL LINKS(NAL 5-14)

Description:

Complete link bar and cover . NAL 5 & 7 complete with a rating of 110A mps and cable max of 16mm². NAL 8 cable max 35mm². NAL 10-14 complete with a rating of 110A mps and cable max 25mm².

Code: NAL5,NAL7,NAL8,NAL10,NAL12,NAL14



P6-125A

P6-250A

P6-500A

DISTRIBUTION BLOCK

Material:P46
Fire resistance: UI94 V-1
Din rail:35mm

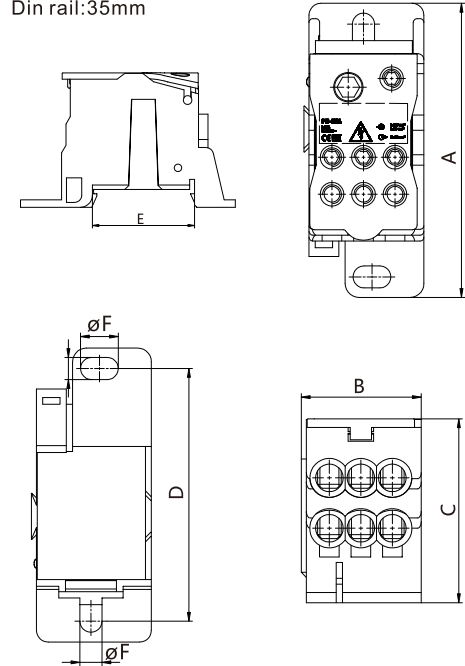

Code	⊖(mm ²)	⊕(mm ²)	A(mm)	B(mm)	C(mm)	D(mm)	E(mm)	øF(mm ²)
P6-80A	1x16	4x6 2x16	65	30.5	47	53	35	9x5.5 11.3x5.5
P6-125A	1x35 1x16	6x16	74	30.5	47	64	35	9.5x5.5
P6-250A	1x120	2x35 5x16 4x10	96	49	50.5	86	35	8x5.7
P6-400A	1x185	2x35 5x16 4x10	96	49	50.5	86	35	8x5.7
P6-500A	3x15 8x24	2x35 5x16 4x10	96	49	50.5	86	35	8x5.7